

Simple,
yet sign
lificant.

mlift

mitsu|lift

Lebanon
 Mitsulift Lebanon S.A.L.
 Mitsulift House
 Dbayeh Main Road
 Metn 2502-5421
 T 961-4-542803
 M 961-3-499336
 F 961-4-542808

Cyprus
 Mitsulift Cyprus Ltd.
 21 Markos Drakos Ave.
 1040 Pallouriotissa
 1621 Nicosia
 P.O. Box: 29078
 T 357-22-793333
 F 357-22-438995

Ghana
 Mitsulift Ghana Ltd.
 Octagon Building, 8th Floor
 Kinbu Garden, Accra Central
 P.O. Box: CT 7667
 Cantonments, Accra
 T 233-302-749002
 M 233-540-121414
 F 233-302-749003

Greece
 Mitsulift Hellas S.A.
 82 Grammou & Artemidos St.
 Moschato
 Athens 18345
 T 30-210-9400848
 F 30-210-9412465

Ivory Coast
 Mitsulift Côte d'Ivoire S.A.
 30 BP 695 Abidjan 30
 T 225-65-769819

Jordan
 Mitsulift Jordan LLC
 Bldg. no. 3, 1st Floor
 Ibrahim Al-Qatan St.
 Hai Rawabi
 7th Circle, Amman
 T 962-6-5885829
 M 962-79-6978958
 F 962-6-5885867

Nigeria
 Mitsulift Nigeria Ltd.
 Nipost Towers
 Block A, 4th Floor
 No 1/3 Ologun Agbaje Street
 Victoria Island, Lagos
 T 234-1-4623808
 M 234-818-000-4111

Syria
 Mitsulift Syria Ltd.
 Rouya 1 Building
 The Eighth Gate, Yafour
 Damascus
 P.O. Box: 3 Yafour
 T 963-11-3943680/1/2/3
 M 963-944-256688
 F 963-11-3943684

Everyday, we wait to get from one place to another – from nothing to something to happen.

mitsulift invites you to fill those grey moments with an elevator that appeals to your senses: mlift.

Product Presentation	04-21
mlift	05
Cabin design	07
Car operating panel	13
Hall operating panel	15
Handrails	17
Ceilings and lights	19
Floors	21
Product Information and Specifications	22-34
Product overview	24-25
Summary of colors, materials and surfaces	26-27
View of landing door	28
View of safety curtain	29
Car & hall operating panels	30-31
Standard features	32-33
Optional features	34
Technical Specifications	35-43
Passenger Lifts MRL without machine room	36-37
Passenger Lifts MR with machine room	38-39
Freight Lifts MRL without machine room	40-41
Freight Lifts MR with machine room	42-43



m|lift Focus on essentials.

**Specifically selected
quality materials and
variations of color
themes.**

m|lift offers smart and simple cabin design with excellent quality performance motors and drives. The focus on essentials means using select high quality materials, colors and accessories to create a coherent yet understated space.

Whether it comes to its clean design, its compactability or its energy efficiency, m|lift aims to provide you with a unique elevator to suit your building needs and the needs of its passengers.

m|lift allows you to create your own elevator cabin with a variety of hand-selected materials that match the character of the building and the people who live or work in it.



**Cabins.
Elevating the body,
and a bit of the soul too.**

**We don't make
elevators,
we create moving
rooms.**

Surfaces appeal to our senses – the clean touch of stainless steel, the satiny acrylic glass on the control panel, the fine interaction between the weaves of the floor mat and the soft rays of light descending from the ceiling.

Our appreciation of quality materials expresses our clear commitment for detail. Although initially machine manufactured, our cabins are custom built and hand finished by our craftsmen. Using laser technology, the cabin walls and edges are cut to guarantee a seamless transition between materials. Each cabin is then assembled by hand from start to finish in compliance with the requirements of EN81 standards.

mLift is available in five different wall colors, two optional ceiling colors and designs, in addition to two further handrail and floor mat variants.



Above: Stainless steel with recommended signalization and accessories.
Opposite: Light Grey with recommended accessories.



Above: Signal Black with recommended signalization and accessories.
Opposite: Signal White with recommended signalization and accessories.



**Car operating panel.
Centerpoint of
your cabin space.**

**From design to final
product – form
meeting function.**

A new car operating system is designed to be user-friendly for passengers through the play of simple design, arrangement of information, materials and surfaces.

Stainless steel combined with materials such as acrylic glass, simple elegant design buttons with LED lighting technology and high resolution TFT display, creates an understated style – at the same time focusing only on the essentials.

Unlike most operating panels, mlift's car operating panel, with a thickness of only 3mm, will blend smoothly and integrate seamlessly into your cabin.

The car operating panel is presented in the following variants for better color matching.

Black
White

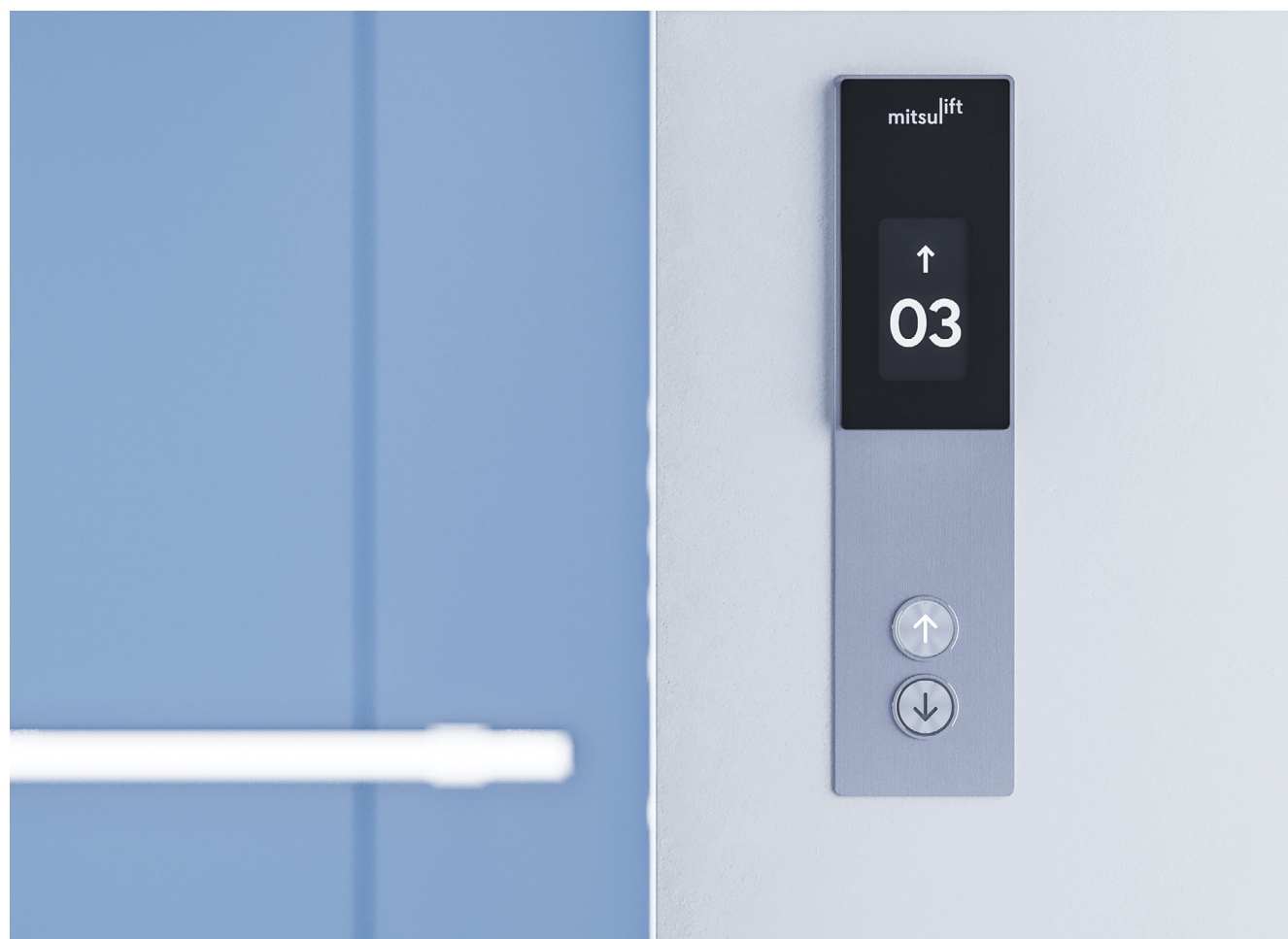

mifit hall operating panel with TFT display – black.

**Hall operating panel.
Visually distinct on
any portal or service
wall.**



mifit hall operating panel with TFT display – white.

**Streamlined look and
feel – with choices of
design.**

The mifit hall operating panel is not only eye-catching on any wall; but it supports numerous functions through its different designs.

mifit's hall operating panel with a fine thickness of 2mm, will guarantee distinguished appeal through its precise thin finishing and craftsmanship.

The panel is available in four different designs to accommodate for individual operations.

Stainless steel faceplate.

Stainless steel faceplate with TFT display.

Stainless steel faceplate with dual TFT display.

The hall operating panel is also presented in the following variants for better color matching to its surroundings.

Black

White



Stainless steel handrail – square variant.

**Handrails.
Solid grip with
a clean touch.**



Stainless steel handrail – round variant.

**Simple and sleek –
perfect to the last
detail.**

Simple handrail designs consisting of simple geometric shapes to create visual harmony inside the cabin.

Every detail in the handrail combines simplicity of form with functionality of materials. The clean touch of stainless steel and its ergonomic build allow for comfortable and solid grip.

Placed on the rear wall of the cabin, it is ideal for additional stability and support for passengers.

mlift presents two optional handrail designs to suit its cabins:

- Round 38mm bar
- Square 40mm bar

Ceiling & Light. Set the mood.



Movable spotlights – available in black or white.

Two variants with two different effects.



Dual light strip – available in black or white.

Light creates ambiance. It bathes the cabin in atmospheric hues and responds to the surrounding surfaces and colors.

mlift presents two lighting systems to suit the cabin atmosphere.

Simple lighting consisting of two strips extending from one side wall to the other for better spread of light inside the cabin.

Two elegantly placed movable spotlights positioned facing the back wall. The spotlights can either be left inside their socket or pulled out and directed to where you need it and how you need it.

In addition to the lights, mlift also provides two optional ceiling colors for its cabins.

Signal Black
Signal White

Floor. A play on tonality and layers.

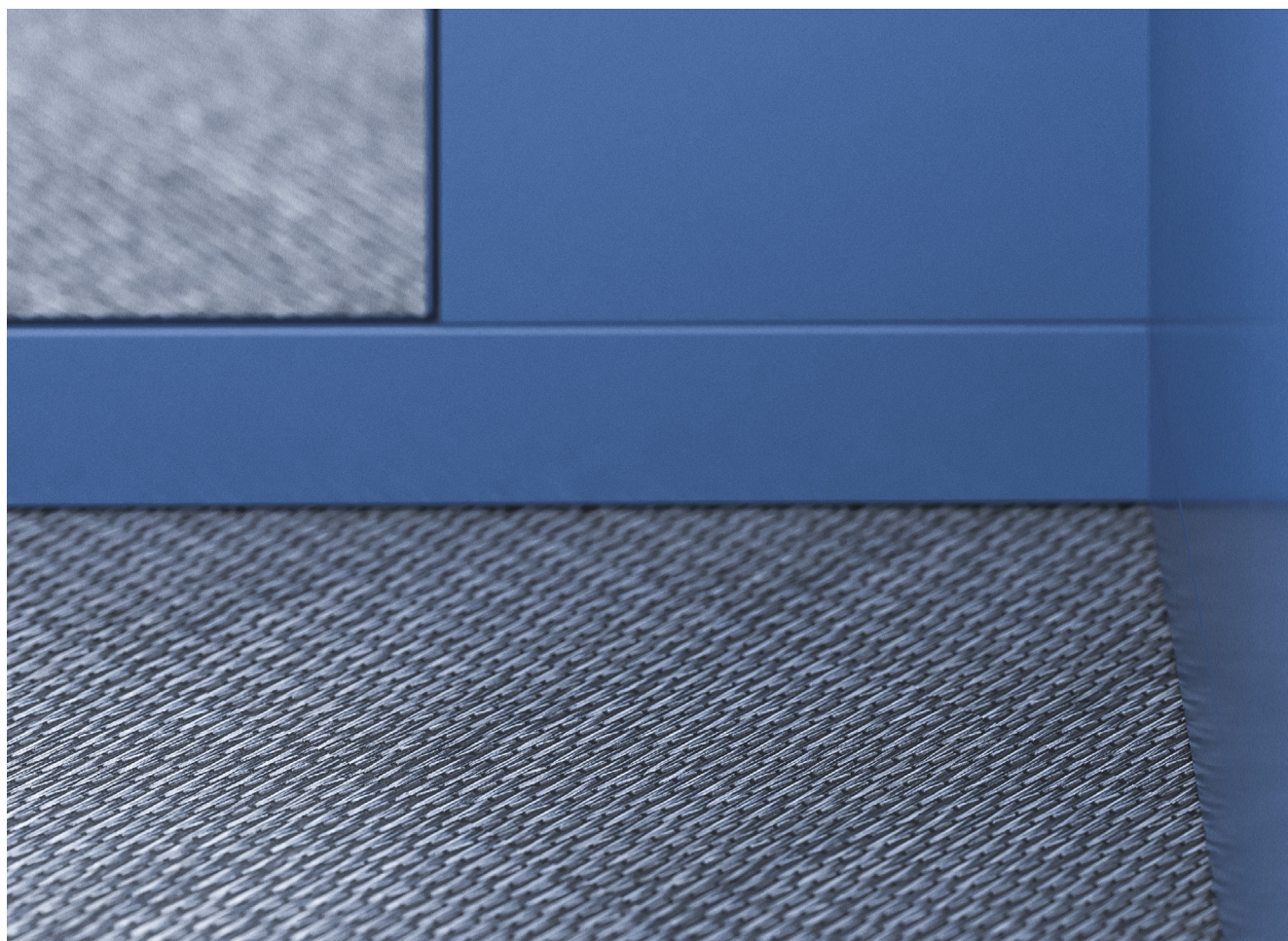

Floor mat in Plain Steel.

Structure and texture add more depth to your cabin.



Floor mat in Plain Black.

Choosing the right floor is essential for any cabin. It can make the space look sharper, add depth, create contrast or simply merge with its surrounding.

mlift presents vinyls inspired from sisal mats, but with a soft, structured yet durable feel. Both vinyls have a delicate classic pattern and a soft, textile feel and structure.

The two floor mats are precisely selected so as to blend with all other elements – making for an outstanding flooring solution with a crisp overall cabin look.

Both mats are weaved with folded yarn and are available in the following tones.

Plain Black
Plain Steel

mlift
Product Information & Specifications

Detail	Description
Car doors, car walls, transom panel and front return panels	Stainless steel sheet with hairline finishing. Plain or painted steel sheet optional in RAL 5024, 7035, 9003, 9004.
Ceiling	Stainless steel with hairline finishing. Painted steel sheet in RAL 9003 Signal White or RAL 9004 Signal Black.
Floor	Vinyl in Plain Black or Steel. 22mm thickness floor reservation – pending client customization.
Kickplate	Same color as cabin walls.
Lighting	Dual strips, indirect, glare-free. Filter panel and light frame in acrylic glass – milky white. Twin spotlights, direct, glare-free. Orientable, each spotlight can be retrieved and directed towards any direction inside the cabin.
Light	LED – natural white.
Mirror (optional)	Mirror glass with splinter protection film. Centered strip positioned on the rear wall and covering the car height. Mirror edges ground & polished – Inset Flush.
Handrail	Round – Ø 38mm bar made from stainless steel with hairline finishing. Handrail holder and handrail ends in stainless steel with hairline finishing. Handrail is placed on either the rear or side wall at 900mm from the ground. Square – 40mm bar made from stainless steel with hairline finishing. Handrail holder and handrail ends in stainless steel with hairline finishing. Handrail is placed on either the rear or side wall at 900mm from the ground.
Car Operating Panel	Stainless steel with hairline finishing, positioned suitable for the handicapped. Concealed attachment with a thickness of 3mm. Information panel in black acrylic glass. Display in high resolution TFT – black background, white information. Emergency messages in red. Short travel buttons in stainless steel, call acceptance in white LED, symbols in yellow. Stainless steel with hairline finishing, positioned suitable for the handicapped. Concealed attachment with a thickness of 3mm. Information panel in white acrylic glass. Display in high resolution TFT – white background, black information. Emergency messages in red. Short travel buttons in stainless steel, call acceptance in white LED, symbols in yellow.
Doors	Telescopic opening – left or right opening option. Central opening.

Detail	Description
Jambs and landing doors	Stainless steel sheets with hairline finishing. Plain or spray painted single color optional in RAL 7044, 7046, 9003, 9004.
Landing Operating Panel	Stainless steel with hairline finishing. Concealed attachment with a thickness of 2mm. Short travel buttons in stainless steel, call acceptance in white LED. Collective single button control. Stainless steel with hairline finishing. Concealed attachment with a thickness of 2mm. Information panel in black acrylic glass. Display in high resolution TFT – black background, white information. Short travel buttons in stainless steel, call acceptance in white LED. Stainless steel with hairline finishing. Concealed attachment with a thickness of 2mm. Information panel in white acrylic glass. Display in high resolution TFT – white background, black information. Short travel buttons in stainless steel, call acceptance in white LED. Stainless steel with hairline finishing. Concealed attachment with a thickness of 2mm. Information panel in black acrylic glass. Dual display in high resolution TFT – black background, white information. Short travel buttons in stainless steel, call acceptance in white LED. Stainless steel with hairline finishing. Concealed attachment with a thickness of 2mm. Information panel in white acrylic glass. Dual display in high resolution TFT – white background, black information. Short travel buttons in stainless steel, call acceptance in white LED.

Car Doors, Car Walls, Transom Panel and Front Return Panels

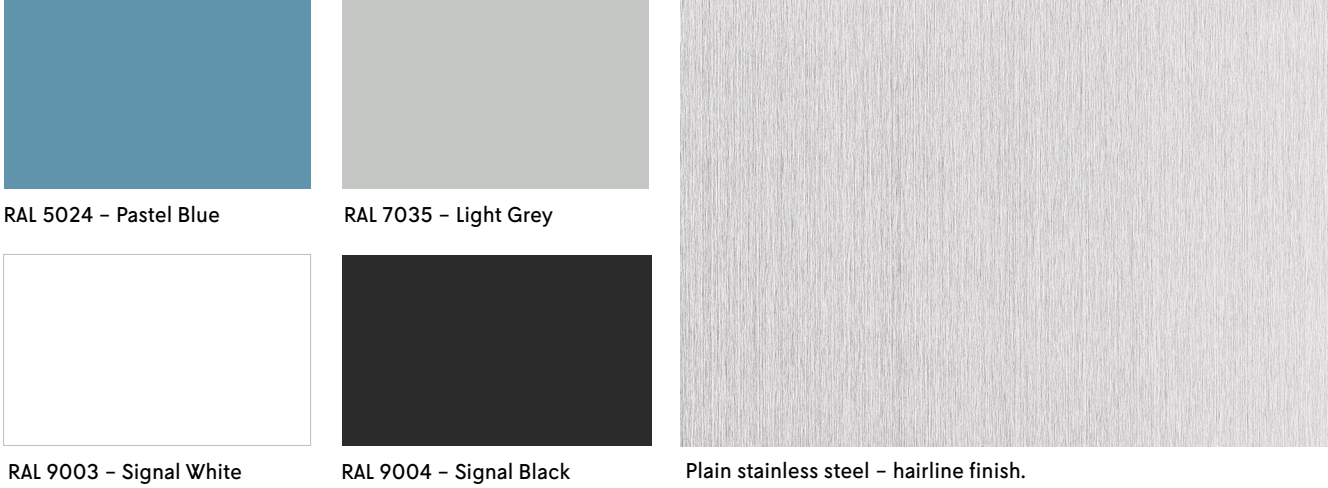

Jams and Landing Doors

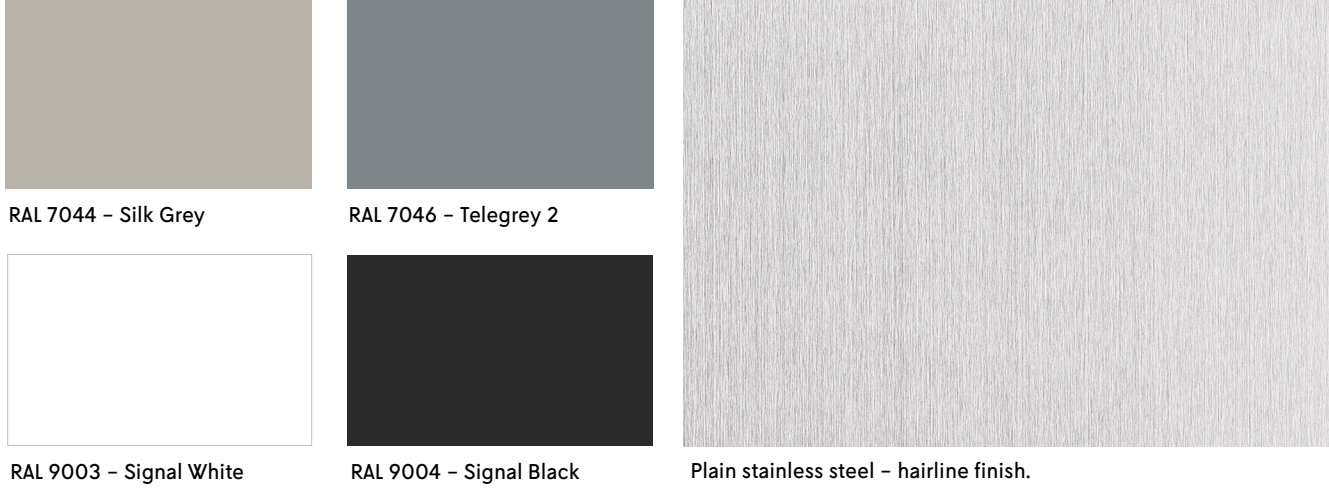

* The RAL colors represented above are close approximations of the actual finished product tones and are used for reference consideration.

Ceiling and Lights



Dual steel light strips - black ceiling and lights variant. Dual steel light strips - white ceiling and lights variant.



Stainless steel spotlight - black variant. Stainless steel spotlight - white variant.

Handrails

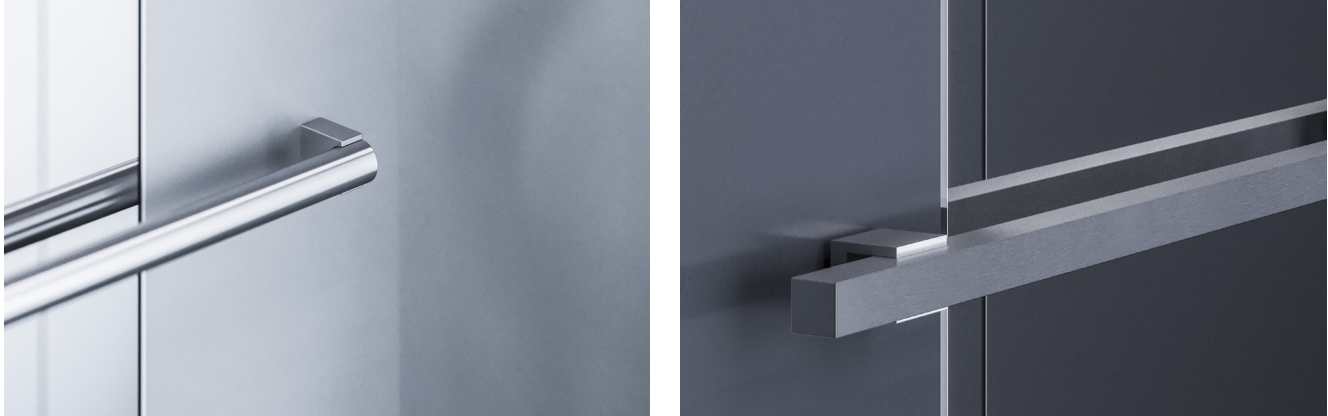

Stainless steel handrail - round variant. Stainless steel handrail - square variant.

Floor Mats

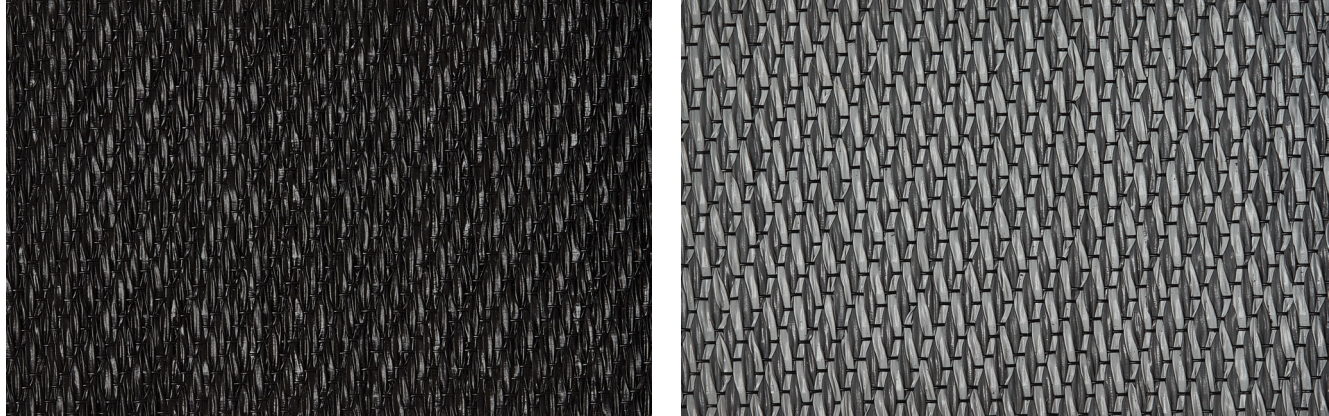

Vinyl floor mat in Plain Black. Vinyl floor mat in Plain Steel.



Landing door in stainless steel variant with hairline finish.

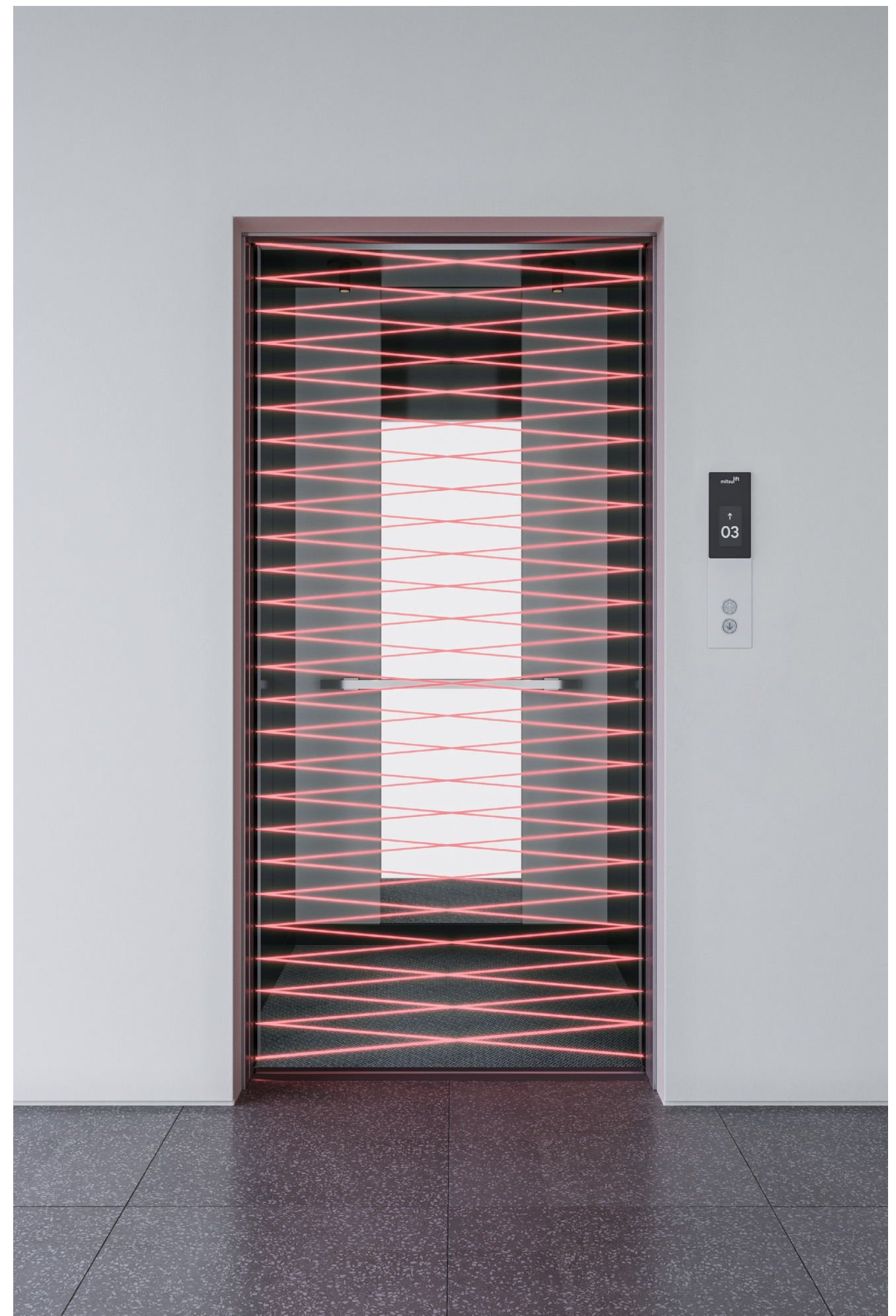

Safety curtain covering the full height of the door opening to detect passengers or objects.

Car Operating Panel

Type	Application	Remarks
Location	Side Wall.	First button starts at 900mm from ground level. Faceplate starting width 200mm. Installation on the right side for CO doors and on the closing side for 2S doors.
Faceplate	Stainless steel with hairline finishing.	Same as above.
	Black acrylic glass. White silkscreen.	Same as above.
	White acrylic glass. Black silkscreen.	Same as above.
Direction and position indicator	High resolution TFT display, black background, white information.	Same as above.
	High resolution TFT display, white background, black information.	Same as above.
No. of Stops	From 2 to 34. Arrangement of buttons vary from 1 to 5 columns.	Same as above.

Hall Operating Panel – Single

Type	Application	Remarks
Application	1 set.	Face plate w 100mm x h 305mm One or two call push button/ s. Face plate w 100mm x h 400mm Up or down arrow push button. Face plate w 100mm x h 400mm Two push buttons for full collective.
Faceplate	Stainless steel with hairline finishing.	Same as above.
	Black acrylic glass. White silkscreen.	Same as above.
	White acrylic glass. Black silkscreen.	Same as above.
Direction and position indicator	No display.	Face plate w 100mm x h 305mm One or two call push button/ s.
	High resolution TFT display, black background, white information.	Face plate w 100mm x h 400mm Up or down arrow push button.
	High resolution TFT display, black background, white information.	Face plate w 100mm x h 400mm Two push buttons for full collective.

	High resolution TFT display, white background, black information.	Face plate w 100mm x h 400mm Up or down arrow push button.
	High resolution TFT display, white background, black information.	Face plate w 100mm x h 400mm Two push buttons for full collective.
Buttons	Flat round buttons in stainless steel. Response LED in white.	Same as above.

Hall Operating Panel – Duplex

Type	Application	Remarks
Application	1 set – 2 cars.	Face plate w 180mm x h 400mm Up and down buttons for full collective.
Faceplate	Stainless steel with hairline finishing.	Same as above.
	Black acrylic glass. White silkscreen.	Same as above.
	White acrylic glass. Black silkscreen.	Same as above.
Direction and position indicator	High resolution TFT display, black background, white information.	Same as above.
	High resolution TFT display, white background, black information.	Same as above.
Buttons	Flat round buttons in stainless steel. Response LED in white.	Same as above.

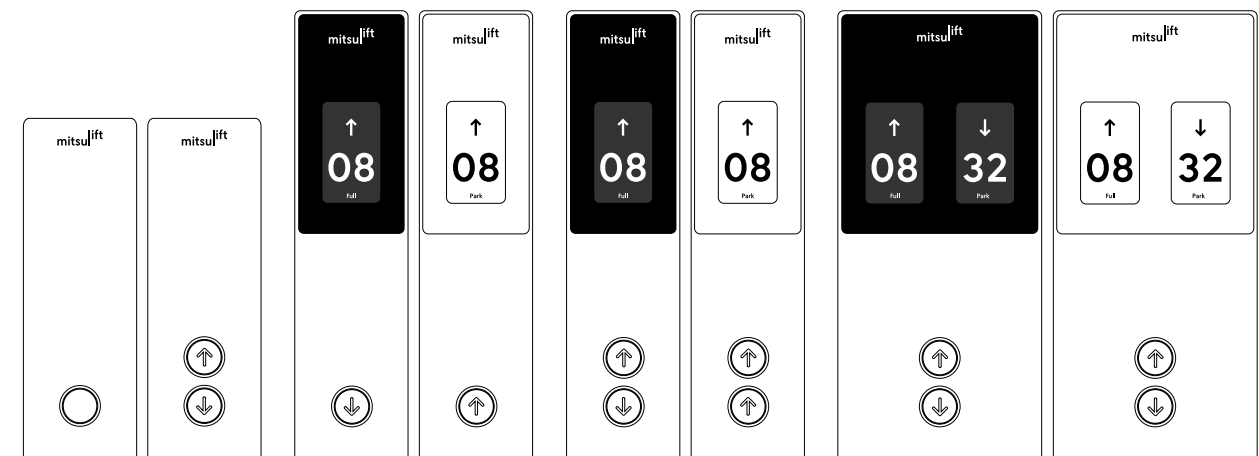

Above: Visual representation of Hall Operating Panel variants.

Standard Features	Description
VVVF Drive	The rotating speed of the motor can be precisely adjusted in order to get a smoother speed curve during lift start, travel and stop.
VVVF Door Operator	VVVF inverter technology is applied to control the elevator doors with a high-speed switching device and a door motor controlled by a microprocessor, displaying steady and high performance at all times and providing efficient and sensitive door open/close operations.
Automatic Bypass	A full car will bypass hall calls in order to maintain maximum operating efficiency.
Automatic Door-Open Time Adjustment	Door opening times are automatically adjusted according to whether the stop was called from the floor or the car.
Reopen with Hall Button	While the doors are closing, they can be reopened by pressing the hall button.
Fast Door Shutting	Pushing down the door-shut button on the control panel will immediately shut the car doors as soon as they open.
False Call Canceling – Car Button Type	If the wrong floor button is pressed, it can be cancelled by pressing the same call button again.
Safety Curtain	Full door height protection system, which utilizes a safety curtain covering the full height of the door opening to detect passengers or objects.
Next Landing	If the elevator doors cannot open fully at the destination floor for any reason, the doors will close and the elevator will proceed to the next floor.
Overload Holding Stop (OLH)	The elevator buzzer rings to indicate the car is overloaded.
Repeated Door-Close	Should an obstacle prevent the doors from closing, the doors will repeatedly open and close until the object is removed.
Emergency Car Lighting (ECL)	Car lighting turns on immediately when power fails to provide a minimum level of lighting in the car. A choice of either dry-cell battery or trickle-charger battery are available.
Inter Communication System	A system which allows communication between passengers inside the car and the building personnel.
Emergency Bell	In case of an emergency, the bell chime on top of the car is activated by continuously pushing down the bell button indicated on the control panel.
Fire Emergency Return	Upon activation of a key switch on the building's fire sensors, all calls are cancelled and all cars immediately return to a specified floor and park there with doors open to ensure safe passenger evacuation.
Car Fan Shut Off – Automatic (CFO-A)	If there is no call within a preset time period, the car fan is automatically shut off to conserve energy.

Standard Features	Description
Car Light Shut Off – Automatic (CLO-A)	If there is no call within a preset time period, the car light is automatically shut off to conserve energy.
Car Arrival Chime – Car	Electronic chime sounds to indicate the car's arrival at the hall. The chime is mounted on the top and bottom part of the car.

Optional Features	Description
Power-on Releveling	If a car stops at a door zone due to the failure of normal power, the car will relevel to secure the floor level with the doors closed after the normal power has recovered.
Landing Open	When a car arrives to a hall, the doors will start opening before the car has completely stopped.
Up Peak Service	Controls the number of cars to be allocated to the main floors, as well as the car allocation timing, in order to meet increased demands for upward travel from the main floors during office starting time, hotel check-in time, etc., and minimize passenger waiting time.
Down Peak Service	Controls the number of cars to be allocated and the timing of the car allocation in order to meet increased demands for downward travel from the main floors during office leaving time, hotel check-out time, etc., and minimize passenger waiting time.
Extended Door-Open Operation	This car button keeps the doors open for an extended period to allow loading of materials, etc.
Main Floor Parking	An available car always parks on the main floor (GF) with the doors open to reduce passenger waiting time.
Voice Guidance System	A synthesized voice instructs passengers on the current status, floor number, etc. - English only.
Flashing Hall Lantern	Hall lanterns flash to indicate the car's arrival and its service direction.
Emergency Landing Device	Upon power failure, a car equipped with this function automatically moves and stops at the nearest floor using a rechargeable battery, and the doors open to ensure passenger safety. This is applicable only when the distance between floors is less than 10 meters.
Fireman's Emergency Operation	During a fire, when the fireman's switch is activated, the car calls of a specified car and all hall calls are cancelled and the car immediately returns to a pre-determined floor. The car then responds only to car calls which facilitates firefighting and rescue operations.
Earthquake Emergency Return (EER-P)	Upon activation of the primary seismic wave sensors, all cars stop at the nearest floor and park there with the doors open to facilitate safe evacuation of passengers.
Dry Contact supply for elevator state signal for BMS - BMS and wiring not provided by mitsulift.	
Reservation for Car Card Reader - Card Reader Device not provided by mitsulift.	
Reservation for Car Card Reader - Card Reader Device not provided by mitsulift.	
Reservation for Hall Card Reader - Card Reader Device not provided by mitsulift.	
Reservation for CCTV - Camera not provided by mitsulift.	
Reservation for Loud Speakers - Loud Speakers not provided by mitsulift.	

mlift Technical Specifications

1. Passenger lifts MRL – without machine room

1.1 Layout plan

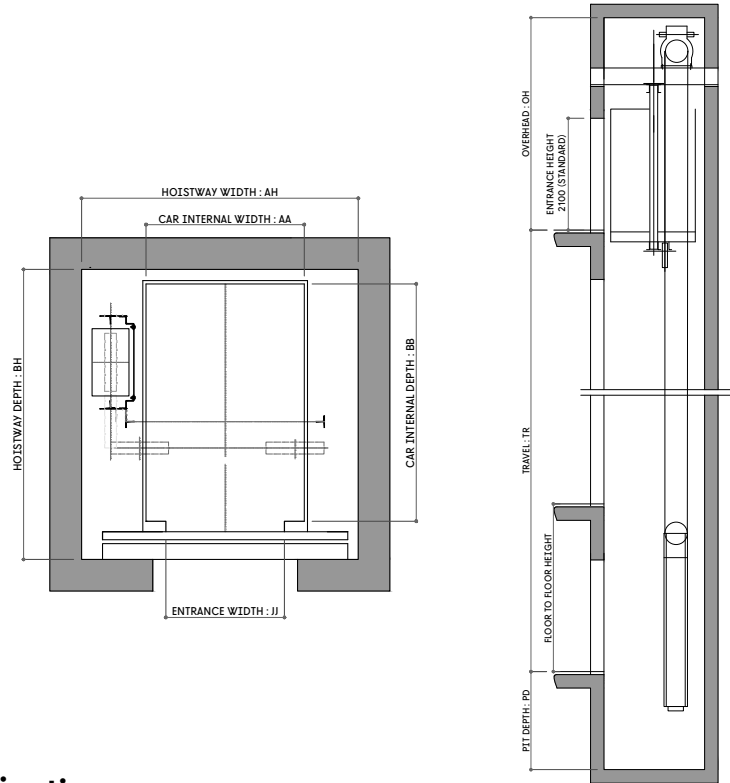

1.3 Application range

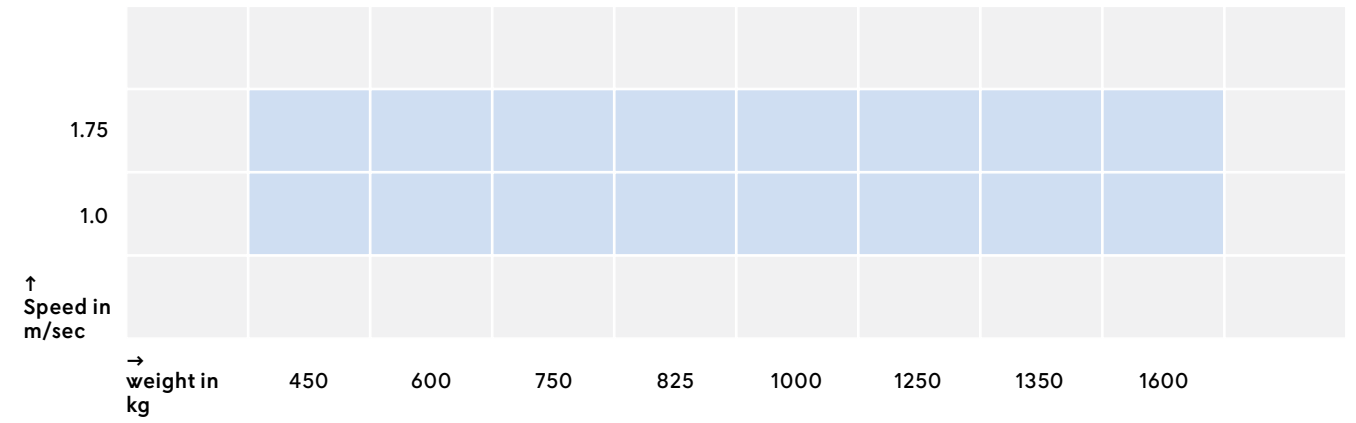

1.2 Technical specifications

The contents of the below table are compliant to standard specifications only. Specifications do not include fireproof landing door and counterweight safety. All information and data are compliant to EN norm.

No. of Persons	Rated Speed in m/sec	Rated Capacity in Kg	Door Type	Entrance Dimensions in mm JJxHH	Car Internal Dimensions in mm AAxBBxHL	Counterweight Position	Minimum Hoistway Dimensions in mm AHxBH/car	Minimum Overhead Dimensions in mm OH	Minimum Pit Depth Dimensions in mm PD
6	1.0 1.75	450	CO	800x2100	1200x1000x2300	Side	2000x1500	4500 4700	1500 1800
8	1.0 1.75	600	CO	800x2100	1100x1400x2300	Side	1900x1900	4500 4700	1500 1800
10	1.0 1.75	750	CO	800x2100	1400x1300x2300	Side	2200x1800	4500 4700	1500 1800
11	1.0 1.75	825	CO	800x2100	1400x1400x2300	Side	2200x1900	4500 4700	1500 1800
13	1.0 1.75	1000	CO	900x2100	1400x1600x2300	Side	2500x2100	4500 4700	1500 1800
16	1.0 1.75	1250	CO	1000x2100	1400x1900x2300	Side	2600x2400	4800 5000	1700 2000
18	1.0 1.75	1350	CO	1000x2100	1400x2100x2300	Side	2600x2600	4800 5000	1700 2000
21	1.0 1.75	1600	CO	1100x2100	1400x2400x2300	Side	2800x2900	4800 5000	1700 2000

2. Passenger lifts MR – with machine room

2.1 Layout plan

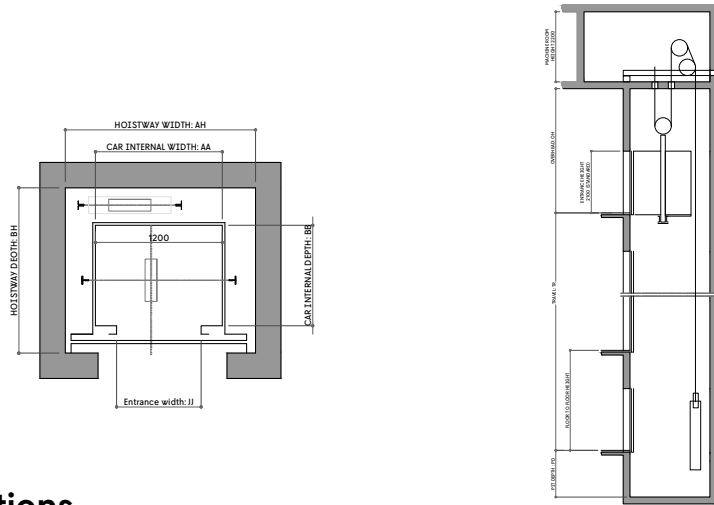

2.2 Technical specifications

The contents of the below table are compliant to standard specifications only. Specifications do not include fireproof landing door and counterweight safety. All information and data are compliant to EN norm.

No. of Persons	Rated Speed in m/sec	Rated Capacity in Kg	Door Type	Entrance Dimensions in mm JJxHH	Car Internal Dimensions in mm AAxBBxHL	Counterweight Position	Minimum Hoistway Dimensions in mm AHxBH/car	Minimum Overhead Dimensions in mm OH	Minimum Pit Depth Dimensions in mm PD	
6	1.0	450	CO / 2S	800x2100	1200x1000x2300	Rear / Side	1800x1600 / 2000x1600	4400	1500	
	1.75									4600
8	1.0	600	CO / 2S	800x2100	1300x1100x2300 / 1100x1400x2300	Rear / Side	1800x1700 / 1900x1900	4400	1500	
	1.75									4600
10	1.0	750	CO / 2S	800x2100	1300x1400x2300	Rear / Side	1800x2000 / 2100x1900	4400	1500	
	1.75									4600
	2.0									4900
11	1.0	825	CO / 2S	800x2100	1400x1400x2300	Rear / Side	1900x2000 / 2200x1900	4400	1500	
	1.75									4600
	2.0									4900
13	1.0	1000	CO / 2S	900x2100	1600x1400x2300 / 1100x2100	Rear / Side	2100x2000 / 1800x2600	4400	1500	
	1.75									4600
	2.0		CO	1600x1400x2300	Rear	2100x2000	4900	1800		
	2.5								5000	
16	1.0	1250	CO / 2S	1000x2100	1800x1500x2300 / 1200x2100	Rear / Side	2500x2200 / 2200x2600	4400	1500	
	1.75									4600
	2.0		CO	1800x1500x2300	Rear	2500x2200	4900	1800		
	2.5								5000	
18	1.0	1350	CO / 2S	1000x2100	1800x1700x2300 / 1300x2200	Rear / Side	2500x2400 / 2300x2700	4400	1500	
	1.75									4600
	2.0		CO	1800x1700x2300	Rear	2500x2400	4900	1800		
	2.5								5000	
21	1.0	1600	CO / 2S	1100x2100	2100x1600x2300 / 1400x2400x2300	Rear / Side	2600x2300 / 2400x2900	4400	1500	
	1.75									4600
	2.0		CO	2100x1600x2300	Rear	2600x2300	4900	1800		
	2.5								5000	

2.3 Application range

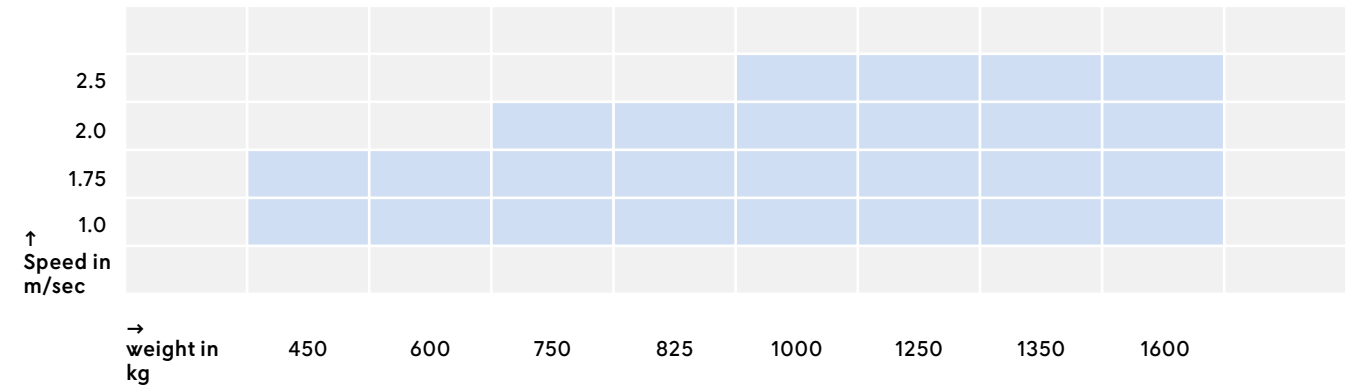

3. Freight lifts MRL – without machine room

3.1 Layout plan

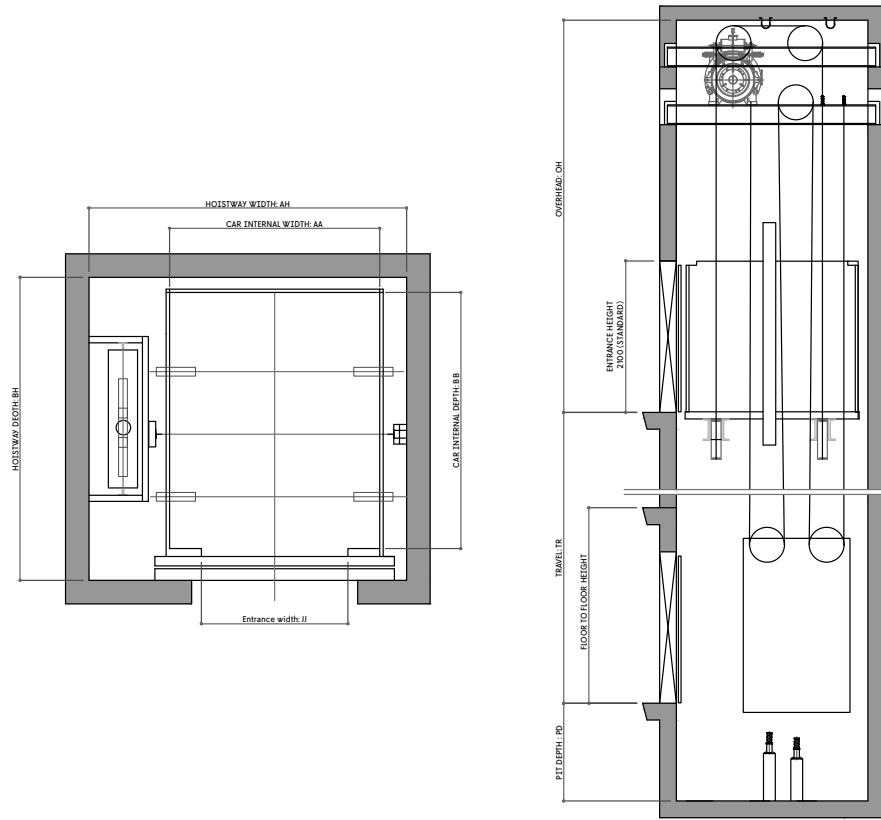

3.3 Application range

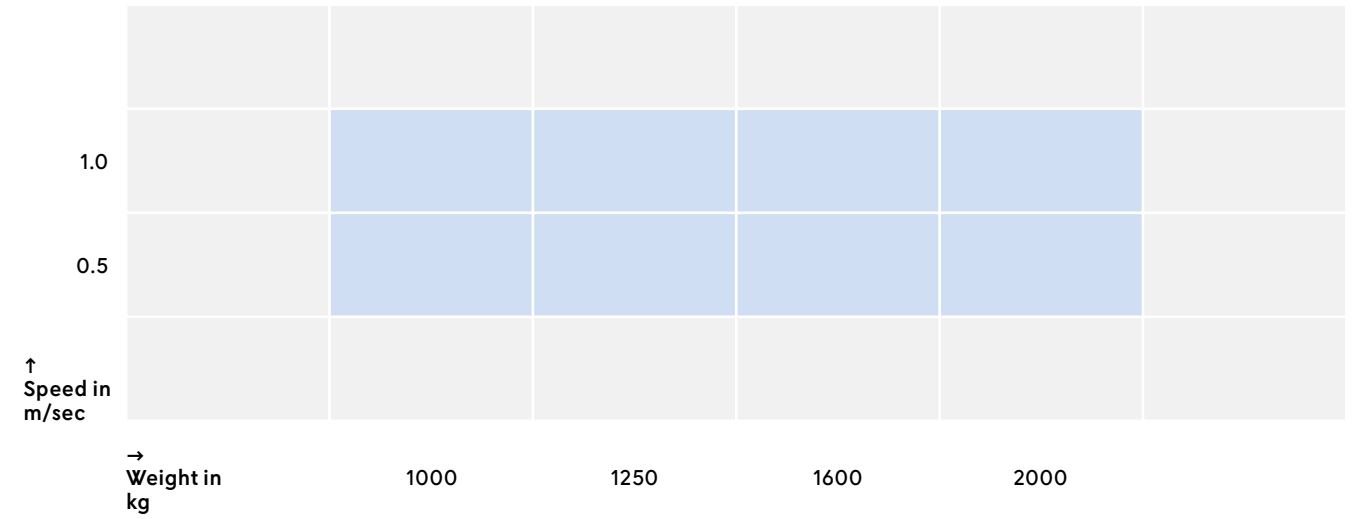

3.2 Technical specifications

The contents of the below table are compliant to standard specifications only. Specifications do not include fireproof landing door and counterweight safety. All information and data are compliant to EN norm.

No. of Persons	Rated Speed in m/sec	Rated Capacity in Kg	Door Type	Entrance Dimensions in mm JJxHH	Car Internal Dimensions in mm AAxBBxHL	Counterweight Position	Minimum Hoistway Dimensions in mm AHxBH/car	Minimum Overhead Dimensions in mm OH	Minimum Pit Depth Dimensions in mm PD
	0.5	1000	CO	900x2100	1600x1400x2300	Side	2400x1800	4600	1600
	1.0								1700
	0.5	1250	CO	1000x2100	1800x1500x2300	Side	3000x2100	4600	1600
	1.0								1700
	0.5	1600	CO	1100x2100	1400x2400x2300	Side	2700x2900	4600	1600
	1.0								1700
	0.5	2000	CO	1700x2100	1700x2400x2300	Side	3000x2900	4800	1700
	1.0								1800

4. Freight lifts MR – with machine room

4.1 Layout plan

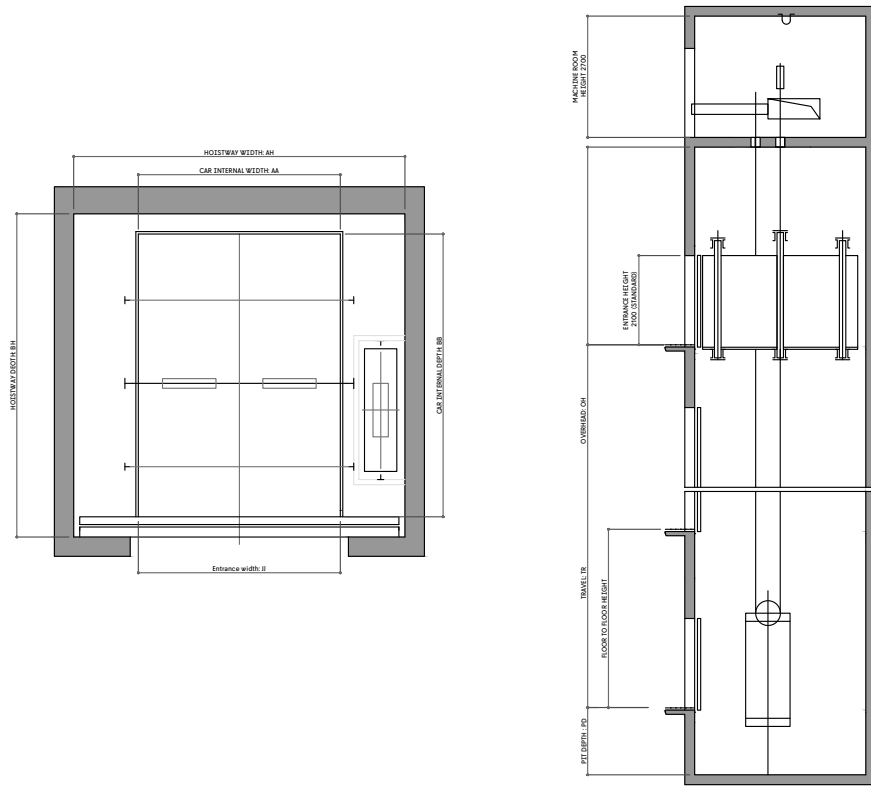

4.3 Application range

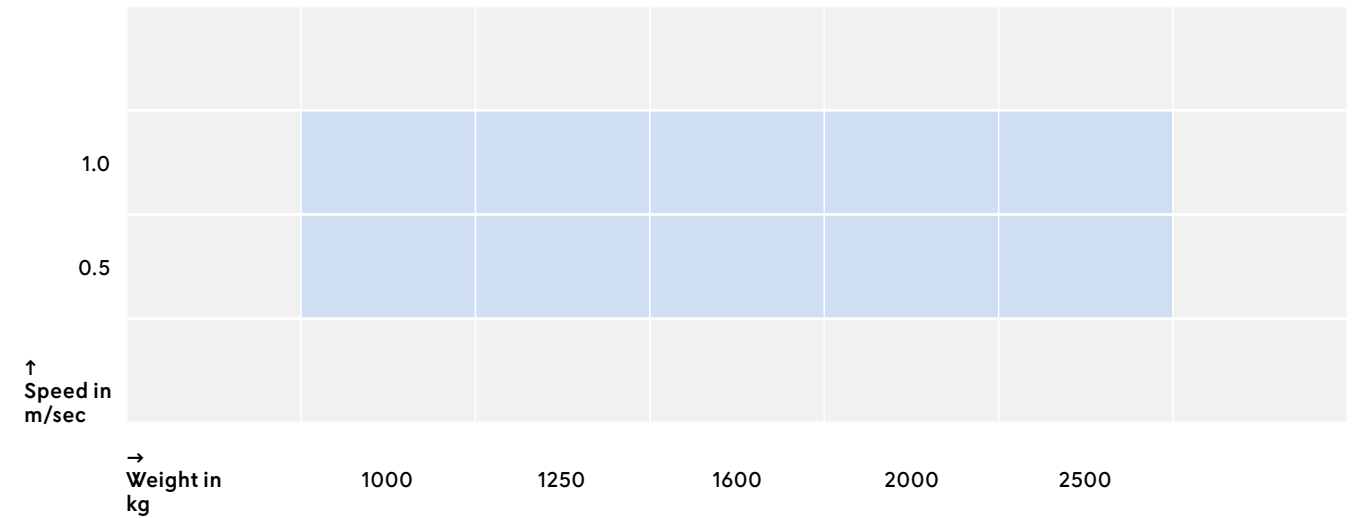

3.2 Technical specifications

The contents of the below table are compliant to standard specifications only. Specifications do not include fireproof landing door and counterweight safety. All information and data are compliant to EN norm. *In the event where the capacity of a freight elevator is in excess of 2500Kg, please refer to our technical department for further information and guidance.

No. of Persons	Rated Speed in m/sec	Rated Capacity in Kg	Door Type	Entrance Dimensions in mm JJxHH	Car Internal Dimensions in mm AAxBBxHL	Counterweight Position	Minimum Hoistway Dimensions in mm AHxBH/car	Minimum Overhead Dimensions in mm OH	Minimum Pit Depth Dimensions in mm PD
	0.5	1000	CO	900x2100	1600x1400x2300	Side	2400x1900	4600	1600
	1.0								1700
	0.5	1250	CO	1000x2100	1800x1500x2300	Side	2600x2000	4600	1600
	1.0								1700
	0.5	1600	CO	1100x2100	1400x2400x2300	Side	2500x2900	4600	1600
	1.0								1700
	0.5	2000	CO	1700x2100	1700x2400x2300	Side	3000x2900	4600	1600
	1.0								1700
	0.5	2500	CO	1700x2100	1700x2800x2300	Side	3100x3300	4600	1600
	1.0								1700

**We design the elevator
that people actually love to take.**

